

# 31

Outer square  
inner circle

# Ron Series

Family of recessed lighting devices, becoming a solution that is integrated into the environment to provide efficient and versatile accent lighting. Designed for LED lamps. For recess mounting in suspended ceilings of up to 30mm thick. Pressed steel powdercoated recessed housing, Stainless steel lamp fixing spring, extruded aluminum recessed trim frame for use with false ceiling systems, powdercoated matt black. The compass adjustment system made of steel allows the adjustment of the lamp in any directions and on any rotation axes. Recessed optical body which reduces the glaring effect of the lamp. For mounting lamp and anti-glare functions. The delayed position of this light source results in great visual comfort.

# RON SERIES

*Light distributions and light colors optimized for an attractive price-performance ratio. This requirement OBT combines in the product ranges with Chip-on-Board LED technology .*

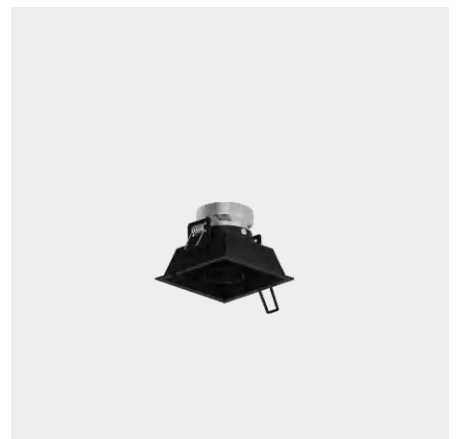
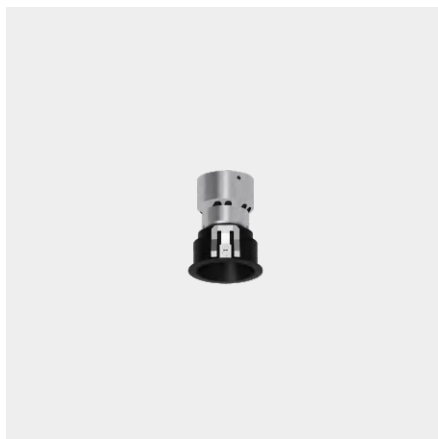
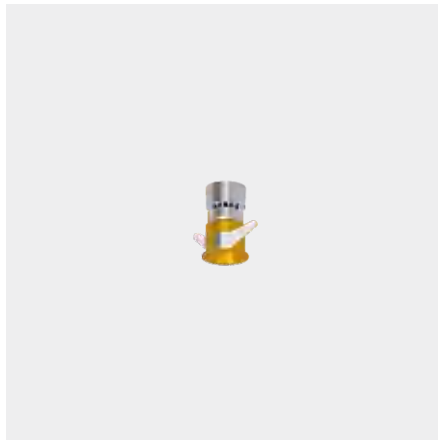





# Ron

Adjustable trim Downlight

-  Ceiling recessed
-  AC 220V~240V
-  Ra 95
-  Lens
-  Class II
-  Ø 35 mm
-  0°~20°
-  0°~355°
-  Matte White (MW)
-  Matte Black (MB)
-  Matte Silver (MS)
-  Matte Gold (MG)



Wattage	Beam Angle	2700K	3000K	3500K	4000K	2700~6500K
Max. 6W	15°	02.3501.MW	02.3502.MW	02.3503.MW	02.3504.MW	02.3517.MW
		02.3501.MB	02.3502.MB	02.3503.MB	02.3504.MB	02.3517.MB
		02.3501.MS	02.3502.MS	02.3503.MS	02.3504.MS	02.3517.MS
		02.3501.MG	02.3502.MG	02.3503.MG	02.3504.MG	02.3517.MG
	24°	02.3505.MW	02.3506.MW	02.3507.MW	02.3508.MW	02.3518.MW
		02.3505.MB	02.3506.MB	02.3507.MB	02.3508.MB	02.3518.MB
		02.3505.MS	02.3506.MS	02.3507.MS	02.3508.MS	02.3518.MS
		02.3505.MG	02.3506.MG	02.3507.MG	02.3508.MG	02.3518.MG
	36°	02.3509.MW	02.3510.MW	02.3511.MW	02.3512.MW	02.3519.MW
		02.3509.MB	02.3510.MB	02.3511.MB	02.3512.MB	02.3519.MB
		02.3509.MS	02.3510.MS	02.3511.MS	02.3512.MS	02.3519.MS
		02.3509.MG	02.3510.MG	02.3511.MG	02.3512.MG	02.3519.MG

Dimming:	On/Off, 1-10V, DALI, TRIAC
UGR:	≤15
SDCM:	≤3
Luminous efficacy:	78lm/W
luminaire Lifetime:	50000h ( L80B10, T a25° C )
Material:	Aluminium
Working Temperature ( °C):	-20° C ~ +45° C
Transformer availability:	LED DC 36V 150mA



# Ron

Adjustable trimless Downlight

-  Ceiling recessed
-  AC 220V~240V
-  Ra 95
-  Lens
-  Class II
-  Ø 40 mm
-  0°~20°
-  0°~355°
-  Matte White (MW)
-  Matte Black (MB)
-  Matte Silver (MS)
-  Matte Gold (MG)

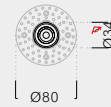
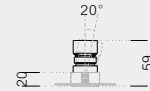

Wattage	Beam Angle	2700K	3000K	3500K	4000K	2700~6500K
Max. 6W	15°	11.4001.MW	11.4002.MW	11.4003.MW	11.4004.MW	11.4017.MW
		11.4001.MB	11.4002.MB	11.4003.MB	11.4004.MB	11.4017.MB
		11.4001.MS	11.4002.MS	11.4003.MS	11.4004.MS	11.4017.MS
		11.4001.MG	11.4002.MG	11.4003.MG	11.4004.MG	11.4017.MG
	24°	11.4005.MW	11.4006.MW	11.4007.MW	11.4008.MW	11.4018.MW
		11.4005.MB	11.4006.MB	11.4007.MB	11.4008.MB	11.4018.MB
		11.4005.MS	11.4006.MS	11.4007.MS	11.4008.MS	11.4018.MS
		11.4005.MG	11.4006.MG	11.4007.MG	11.4008.MG	11.4018.MG
	36°	11.4009.MW	11.4010.MW	11.4011.MW	11.4012.MW	11.4019.MW
		11.4009.MB	11.4010.MB	11.4011.MB	11.4012.MB	11.4019.MB
		11.4009.MS	11.4010.MS	11.4011.MS	11.4012.MS	11.4019.MS
		11.4009.MG	11.4010.MG	11.4011.MG	11.4012.MG	11.4019.MG

Dimming:

UGR:

SDCM:

Luminous efficacy:

luminaire Lifetime:

Material:

Working Temperature ( °C):

Transformer availability:

On/Off, 1-10V, DALI, TRIAC

≤15

≤3

78lm/W

50000h ( L80B10, T a25° C )

Aluminium

-20° C ~ +45° C

LED DC 36V 150mA



# Ron

Adjustable trim Downlight

-  Ceiling recessed
-  AC 220V~240V
-  Ra 95
-  Lens
-  Class II
-  Ø 55 mm
-  0°~20°
-  0°~355°
-  Matte White (MW)
-  Matte Black (MB)
-  Matte Silver (MS)
-  Matte Gold (MG)

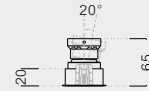

Wattage	Beam Angle	2700K	3000K	3500K	4000K	2700~6500K
Max. 8W	15°	02.5501.MW	02.5502.MW	02.5503.MW	02.5504.MW	02.5533.MW
		02.5501.MB	02.5502.MB	02.5503.MB	02.5504.MB	02.5533.MB
		02.5501.MS	02.5502.MS	02.5503.MS	02.5504.MS	02.5533.MS
		02.5501.MG	02.5502.MG	02.5503.MG	02.5504.MG	02.5533.MG
	24°	02.5505.MW	02.5506.MW	02.5507.MW	02.5508.MW	02.5534.MW
		02.5505.MB	02.5506.MB	02.5507.MB	02.5508.MB	02.5534.MB
		02.5505.MS	02.5506.MS	02.5507.MS	02.5508.MS	02.5534.MS
		02.5505.MG	02.5506.MG	02.5507.MG	02.5508.MG	02.5534.MG
	36°	02.5509.MW	02.5510.MW	02.5511.MW	02.5512.MW	02.5535.MW
		02.5509.MB	02.5510.MB	02.5511.MB	02.5512.MB	02.5535.MB
		02.5509.MS	02.5510.MS	02.5511.MS	02.5512.MS	02.5535.MS
		02.5509.MG	02.5510.MG	02.5511.MG	02.5512.MG	02.5535.MG
	50°	02.5513.MW	02.5514.MW	02.5515.MW	02.5516.MW	02.5536.MW
		02.5513.MB	02.5514.MB	02.5515.MB	02.5516.MB	02.5536.MB
		02.5513.MS	02.5514.MS	02.5515.MS	02.5516.MS	02.5536.MS
		02.5513.MG	02.5514.MG	02.5515.MG	02.5516.MG	02.5536.MG

Dimming:	On/Off, 1-10V, DALI, TRIAC
UGR:	≤15
SDCM:	≤3
Luminous efficacy:	78lm/W
luminaire Lifetime:	50000h ( L80B10, T a25° C )
Material:	Aluminium
Working Temperature ( °C):	-20° C ~ +45° C
Transformer availability:	LED DC 36V 200mA



# Ron

Adjustable trimless Downlight

-  Ceiling recessed
-  AC 220V~240V
-  Ra 95
-  Lens
-  Class II
-  Ø 55 mm
-  0°~20°
-  0°~355°
-  Matte White (MW)
-  Matte Black (MB)
-  Matte Silver (MS)
-  Matte Gold (MG)

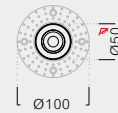

Wattage	Beam Angle	2700K	3000K	3500K	4000K	2700~6500K
Max. 8W	15°	11.5501.MW	11.5502.MW	11.5503.MW	11.5504.MW	11.5533.MW
		11.5501.MB	11.5502.MB	11.5503.MB	11.5504.MB	11.5533.MB
		11.5501.MS	11.5502.MS	11.5503.MS	11.5504.MS	11.5533.MS
		11.5501.MG	11.5502.MG	11.5503.MG	11.5504.MG	11.5533.MG
	24°	11.5505.MW	11.5506.MW	11.5507.MW	11.5508.MW	11.5534.MW
		11.5505.MB	11.5506.MB	11.5507.MB	11.5508.MB	11.5534.MB
		11.5505.MS	11.5506.MS	11.5507.MS	11.5508.MS	11.5534.MS
		11.5505.MG	11.5506.MG	11.5507.MG	11.5508.MG	11.5534.MG
	36°	11.5509.MW	11.5510.MW	11.5511.MW	11.5512.MW	11.5535.MW
		11.5509.MB	11.5510.MB	11.5511.MB	11.5512.MB	11.5535.MB
		11.5509.MS	11.5510.MS	11.5511.MS	11.5512.MS	11.5535.MS
		11.5509.MG	11.5510.MG	11.5511.MG	11.5512.MG	11.5535.MG
	50°	11.5513.MW	11.5514.MW	11.5515.MW	11.5516.MW	11.5536.MW
		11.5513.MB	11.5514.MB	11.5515.MB	11.5516.MB	11.5536.MB
		11.5513.MS	11.5514.MS	11.5515.MS	11.5516.MS	11.5536.MS
		11.5513.MG	11.5514.MG	11.5515.MG	11.5516.MG	11.5536.MG

Dimming:	On/Off, 1-10V, DALI, TRIAC
UGR:	≤15
SDCM:	≤3
Luminous efficacy:	78lm/W
luminaire Lifetime:	50000h ( L80B10, T a25° C )
Material:	Aluminium
Working Temperature ( °C):	-20° C ~ +45° C
Transformer availability:	LED DC 36V 200mA





# Ron

Adjustable trim Downlight

-  Ceiling recessed
-  AC 220V~240V
-  Ra 95
-  Lens
-  Class II
-  Ø 55 mm
-  0°~20°
-  0°~355°
-  Matte White (MW)
-  Matte Black (MB)
-  Matte Silver (MS)
-  Matte Gold (MG)

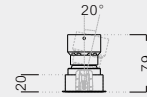

Wattage	Beam Angle	2700K	3000K	3500K	4000K	2700~6500K
Max. 12W	15°	02.5517.MW	02.5518.MW	02.5519.MW	02.5520.MW	02.5537.MW
		02.5517.MB	02.5518.MB	02.5519.MB	02.5520.MB	02.5537.MB
		02.5517.MS	02.5518.MS	02.5519.MS	02.5520.MS	02.5537.MS
		02.5517.MG	02.5518.MG	02.5519.MG	02.5520.MG	02.5537.MG
	24°	02.5521.MW	02.5522.MW	02.5523.MW	02.5524.MW	02.5538.MW
		02.5521.MB	02.5522.MB	02.5523.MB	02.5524.MB	02.5538.MB
		02.5521.MS	02.5522.MS	02.5523.MS	02.5524.MS	02.5538.MS
		02.5521.MG	02.5522.MG	02.5523.MG	02.5524.MG	02.5538.MG
	36°	02.5525.MW	02.5526.MW	02.5527.MW	02.5528.MW	02.5539.MW
		02.5525.MB	02.5526.MB	02.5527.MB	02.5528.MB	02.5539.MB
		02.5525.MS	02.5526.MS	02.5527.MS	02.5528.MS	02.5539.MS
		02.5525.MG	02.5526.MG	02.5527.MG	02.5528.MG	02.5539.MG
	50°	02.5529.MW	02.5530.MW	02.5531.MW	02.5532.MW	02.5540.MW
		02.5529.MB	02.5530.MB	02.5531.MB	02.5532.MB	02.5540.MB
		02.5529.MS	02.5530.MS	02.5531.MS	02.5532.MS	02.5540.MS
		02.5529.MG	02.5530.MG	02.5531.MG	02.5532.MG	02.5540.MG

Dimming: On/Off, 1-10V, DALI, TRIAC  
 UGR: ≤15  
 SDCM: ≤3  
 Luminous efficacy: 78lm/W  
 luminaire Lifetime: 50000h ( L80B10, T a25° C )  
 Material: Aluminium  
 Working Temperature ( °C ): -20° C ~ +45° C  
 Transformer availability: LED DC 36V 300mA



# Ron

Adjustable trimless Downlight

-  Ceiling recessed
-  AC 220V~240V
-  Ra 95
-  Lens
-  Class II
-  Ø 55 mm
-  0°~20°
-  0°~355°
-  Matte White (MW)
-  Matte Black (MB)
-  Matte Silver (MS)
-  Matte Gold (MG)

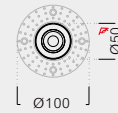

Wattage	Beam Angle	2700K	3000K	3500K	4000K	2700~6500K
Max. 12W	15°	11.5517.MW	11.5518.MW	11.5519.MW	11.5520.MW	11.5537.MW
		11.5517.MB	11.5518.MB	11.5519.MB	11.5520.MB	11.5537.MB
		11.5517.MS	11.5518.MS	11.5519.MS	11.5520.MS	11.5537.MS
		11.5517.MG	11.5518.MG	11.5519.MG	11.5520.MG	11.5537.MG
	24°	11.5521.MW	11.5522.MW	11.5523.MW	11.5524.MW	11.5538.MW
		11.5521.MB	11.5522.MB	11.5523.MB	11.5524.MB	11.5538.MB
		11.5521.MS	11.5522.MS	11.5523.MS	11.5524.MS	11.5538.MS
		11.5521.MG	11.5522.MG	11.5523.MG	11.5524.MG	11.5538.MG
	36°	11.5525.MW	11.5526.MW	11.5527.MW	11.5528.MW	11.5539.MW
		11.5525.MB	11.5526.MB	11.5527.MB	11.5528.MB	11.5539.MB
		11.5525.MS	11.5526.MS	11.5527.MS	11.5528.MS	11.5539.MS
		11.5525.MG	11.5526.MG	11.5527.MG	11.5528.MG	11.5539.MG
	50°	11.5529.MW	11.5530.MW	11.5531.MW	11.5532.MW	11.5540.MW
		11.5529.MB	11.5530.MB	11.5531.MB	11.5532.MB	11.5540.MB
		11.5529.MS	11.5530.MS	11.5531.MS	11.5532.MS	11.5540.MS
		11.5529.MG	11.5530.MG	11.5531.MG	11.5532.MG	11.5540.MG

Dimming:	On/Off, 1-10V, DALI, TRIAC
UGR:	≤15
SDCM:	≤3
Luminous efficacy:	78lm/W
luminaire Lifetime:	50000h ( L80B10, T a25° C )
Material:	Aluminium
Working Temperature ( °C):	-20° C ~ +45° C
Transformer availability:	LED DC 36V 300mA



# Ron

Adjustable trim Downlight

-  Ceiling recessed
-  AC 220V~240V
-  Ra 95
-  Lens
-  Class II
-  Ø 75 mm
-  0°~20°
-  0°~355°
-  Matte White (MW)
-  Matte Black (MB)
-  Matte Silver (MS)
-  Matte Gold (MG)

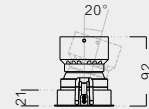

Wattage	Beam Angle	2700K	3000K	3500K	4000K	2700~6500K
Max. 15W	15°	02.7501.MW	02.7502.MW	02.7503.MW	02.7504.MW	02.7517.MW
		02.7501.MB	02.7502.MB	02.7503.MB	02.7504.MB	02.7517.MB
		02.7501.MS	02.7502.MS	02.7503.MS	02.7504.MS	02.7517.MS
		02.7501.MG	02.7502.MG	02.7503.MG	02.7504.MG	02.7517.MG
	24°	02.7505.MW	02.7506.MW	02.7507.MW	02.7508.MW	02.7518.MW
		02.7505.MB	02.7506.MB	02.7507.MB	02.7508.MB	02.7518.MB
		02.7505.MS	02.7506.MS	02.7507.MS	02.7508.MS	02.7518.MS
		02.7505.MG	02.7506.MG	02.7507.MG	02.7508.MG	02.7518.MG
	36°	02.7509.MW	02.7510.MW	02.7511.MW	02.7512.MW	02.7519.MW
		02.7509.MB	02.7510.MB	02.7511.MB	02.7512.MB	02.7519.MB
		02.7509.MS	02.7510.MS	02.7511.MS	02.7512.MS	02.7519.MS
		02.7509.MG	02.7510.MG	02.7511.MG	02.7512.MG	02.7519.MG
	50°	02.7513.MW	02.7514.MW	02.7515.MW	02.7516.MW	02.7520.MW
		02.7513.MB	02.7514.MB	02.7515.MB	02.7516.MB	02.7520.MB
		02.7513.MS	02.7514.MS	02.7515.MS	02.7516.MS	02.7520.MS
		02.7513.MG	02.7514.MG	02.7515.MG	02.7516.MG	02.7520.MG

Dimming:	On/Off, 1-10V, DALI, TRIAC
UGR:	≤15
SDCM:	≤3
Luminous efficacy:	78lm/W
luminaire Lifetime:	50000h ( L80B10, T a25° C )
Material:	Aluminium
Working Temperature ( °C):	-20° C ~ +45° C
Transformer availability:	LED DC 36V 350mA



# Ron

Adjustable trimless Downlight

-  Ceiling recessed
-  AC 220V~240V
-  Ra 95
-  Lens
-  Class II
-  Ø 75 mm
-  0°~20°
-  0°~355°
-  Matte White (MW)
-  Matte Black (MB)
-  Matte Silver (MS)
-  Matte Gold (MG)

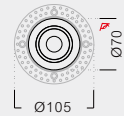
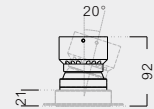

Wattage	Beam Angle	2700K	3000K	3500K	4000K	2700~6500K
Max. 15W	15°	11.7501.MW	11.7502.MW	11.7503.MW	11.7504.MW	11.7517.MW
		11.7501.MB	11.7502.MB	11.7503.MB	11.7504.MB	11.7517.MB
		11.7501.MS	11.7502.MS	11.7503.MS	11.7504.MS	11.7517.MS
		11.7501.MG	11.7502.MG	11.7503.MG	11.7504.MG	11.7517.MG
	24°	11.7505.MW	11.7506.MW	11.7507.MW	11.7508.MW	11.7518.MW
		11.7505.MB	11.7506.MB	11.7507.MB	11.7508.MB	11.7518.MB
		11.7505.MS	11.7506.MS	11.7507.MS	11.7508.MS	11.7518.MS
		11.7505.MG	11.7506.MG	11.7507.MG	11.7508.MG	11.7518.MG
	36°	11.7509.MW	11.7510.MW	11.7511.MW	11.7512.MW	11.7519.MW
		11.7509.MB	11.7510.MB	11.7511.MB	11.7512.MB	11.7519.MB
		11.7509.MS	11.7510.MS	11.7511.MS	11.7512.MS	11.7519.MS
		11.7509.MG	11.7510.MG	11.7511.MG	11.7512.MG	11.7519.MG
	50°	11.7513.MW	11.7514.MW	11.7515.MW	11.7516.MW	11.7520.MW
		11.7513.MB	11.7514.MB	11.7515.MB	11.7516.MB	11.7520.MB
		11.7513.MS	11.7514.MS	11.7515.MS	11.7516.MS	11.7520.MS
		11.7513.MG	11.7514.MG	11.7515.MG	11.7516.MG	11.7520.MG

Dimming:	On/Off, 1-10V, DALI, TRIAC
UGR:	≤15
SDCM:	≤3
Luminous efficacy:	78lm/W
luminaire Lifetime:	50000h ( L80B10, T a25° C )
Material:	Aluminium
Working Temperature ( °C):	-20° C ~ +45° C
Transformer availability:	LED DC 36V 350mA







# Ron

-  Ceiling recessed
-  AC 220V~240V
-  Ra 95
-  Lens
-  Class II
-  L75\*W75 mm
-  0°~20°
-  0°~355°
-  Matte White (MW)
-  Matte Black (MB)

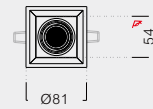
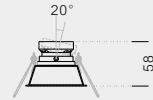

Wattage	Beam Angle	2700K	3000K	3500K	4000K	2700~6500K
Max. 8W	15°	02.7551.MW 02.7551.MB	02.7552.MW 02.7552.MB	02.7553.MW 02.7553.MB	02.7554.MW 02.7554.MB	02.7583.MW 02.7583.MB
	24°	02.7555.MW 02.7555.MB	02.7556.MW 02.7556.MB	02.7557.MW 02.7557.MB	02.7558.MW 02.7558.MB	02.7584.MW 02.7584.MB
	36°	02.7559.MW 02.7559.MB	02.7560.MW 02.7560.MB	02.7561.MW 02.7561.MB	02.7562.MW 02.7562.MB	02.7585.MW 02.7585.MB
	50°	02.7563.MW 02.7563.MB	02.7564.MW 02.7564.MB	02.7565.MW 02.7565.MB	02.7566.MW 02.7566.MB	02.7586.MW 02.7586.MB

Dimming: On/Off, 1-10V, DALI, TRIAC  
 UGR: ≤15  
 SDCM: ≤3  
 Luminous efficacy: 78lm/W  
 luminaire Lifetime: 50000h ( L80B10, T a25° C )  
 Material: Aluminium  
 Working Temperature ( °C): -20° C ~ +45° C  
 Transformer availability: LED DC 36V 200mA



# Ron

Adjustable trim Downlight

-  Ceiling recessed
-  AC 220V~240V
-  Ra 95
-  Lens
-  Class II
-  L75\*W75 mm
-  0°~20°
-  0°~355°
-  Matte White (MW)
-  Matte Black (MB)

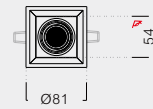
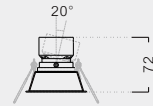

Wattage	Beam Angle	2700K	3000K	3500K	4000K	2700~6500K
Max. 12W	15°	02.7567.MW 02.7567.MB	02.7568.MW 02.7568.MB	02.7569.MW 02.7569.MB	02.7570.MW 02.7570.MB	02.7587.MW 02.7587.MB
	24°	02.7571.MW 02.7571.MB	02.7572.MW 02.7572.MB	02.7573.MW 02.7573.MB	02.7574.MW 02.7574.MB	02.7588.MW 02.7588.MB
	36°	02.7575.MW 02.7575.MB	02.7576.MW 02.7576.MB	02.7577.MW 02.7577.MB	02.7578.MW 02.7578.MB	02.7589.MW 02.7589.MB
	50°	02.7579.MW 02.7579.MB	02.7580.MW 02.7580.MB	02.7581.MW 02.7581.MB	02.7582.MW 02.7582.MB	02.7590.MW 02.7590.MB

Dimming: On/Off, 1-10V, DALI, TRIAC  
 UGR: ≤15  
 SDCM: ≤3  
 Luminous efficacy: 78lm/W  
 luminaire Lifetime: 50000h ( L80B10, T a25° C )  
 Material: Aluminium  
 Working Temperature ( °C): -20° C ~ +45° C  
 Transformer availability: LED DC 36V 300mA





# Installation Schemes

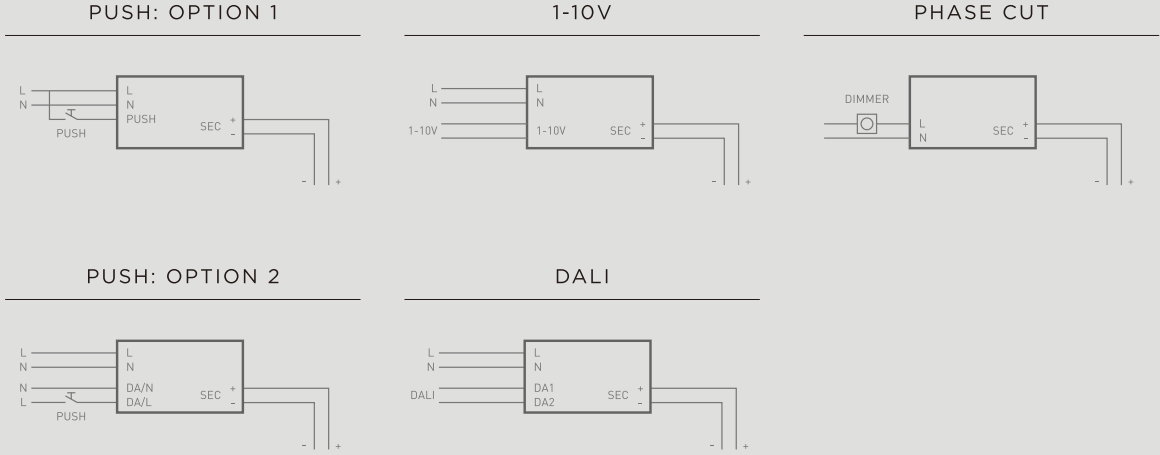

# Connection Tips

SEVERAL FIXTURES CONNECTION TO A SINGLE CONSTANT CURRENT DRIVER

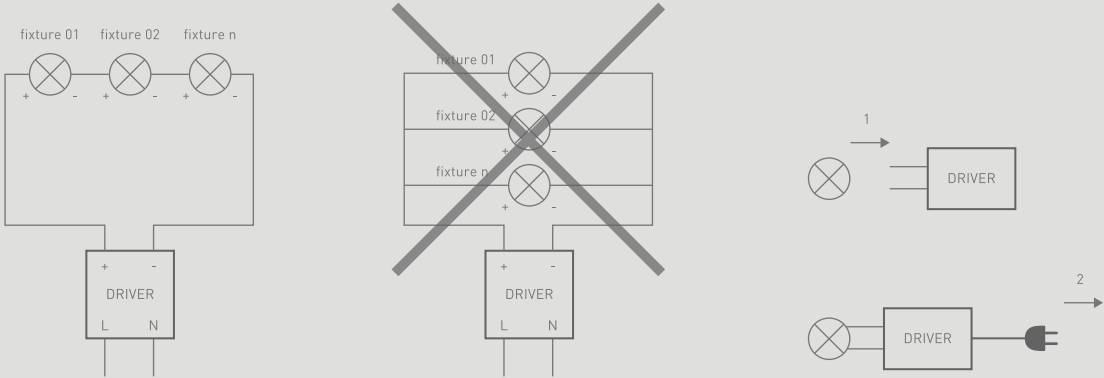

# Trimless Mounting

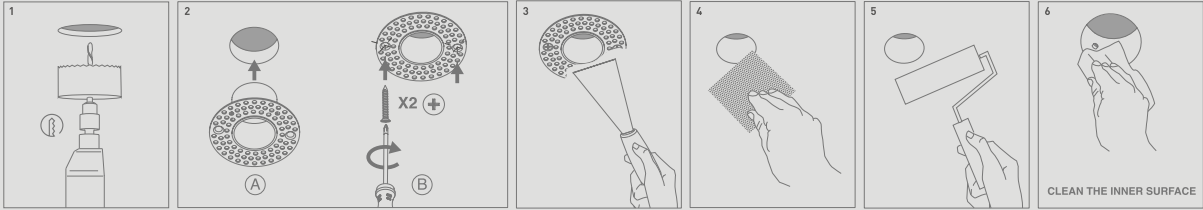

*Publication date: December 2022*

*©Copyright OBT lighting*

*With thank to all contributors for the realization of this catalogue*

*Designed by OBT lighting Graphic Design Department*

*No part of this catalogue may be copied without written authorization of OBT lighting*



## **OBT LIGHTING LIMITED**

Unit G1 Capital House 61  
Amhurst Road, London,  
United Kingdom, E8 1LL  
services@obtlighting.cn  
Hotline : 400 090 2289

[www.obt.ltd](http://www.obt.ltd)



Floor 2, No. 979, Yunhan  
Road, Lingang New District,  
China (Shanghai) pilot Free  
Trade Zone  
services@obtlighting.cn  
Hotline : 400 090 2289

[www.obt.ltd](http://www.obt.ltd)

Office 5, 8/F, Mega Cube,  
8 Wang Kwong Road, Kowloon  
Bay, Kowloon, Hong Kong  
services@obtlighting.cn  
Hotline : 400 090 2289

[www.obt.ltd](http://www.obt.ltd)

Room 201, building 3, No. 67,  
Luoja Nanyue street, Dalong  
street, Panyu District,  
Guangzhou  
services@obtlighting.cn  
Hotline : 400 090 2289

[www.obt.ltd](http://www.obt.ltd)