

Optical Kit  
Fixed / Adjustable

Mounting Accessories  
Trim / Trimless

# Cabin



# 7

Cut Dimension  
Ø70 mm / Ø120 mm

The natural evolution from the Light Shadow Dots. They offer extremely high effectiveness despite their small size and compact body.

# Combine and change your colour in a few seconds

Decorative ring finishes



CABIN

Matte gold

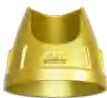

Matte copper



Matte Silver



Matte White



Matte Black



# CABIN SERIES

*The reflector can be selected in 5 colors to meet the needs of different occasions. It has undergone precise design, adopts electroplating and nano spray painting technology for high reflection efficiency, and provides a comfortable light type with high efficiency.*





BUTTERFLY



# CABIN

## INSTALLATION INSTRUCTIONS

01

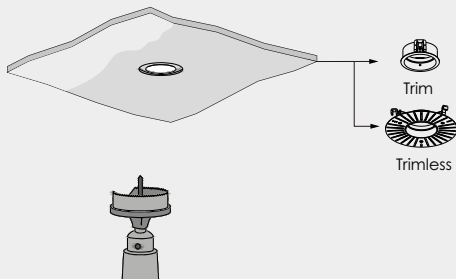

Ceiling cut inner hole  $\Phi$  120mm,  
and out hole  $\Phi$  150mm, depth 5mm.

02

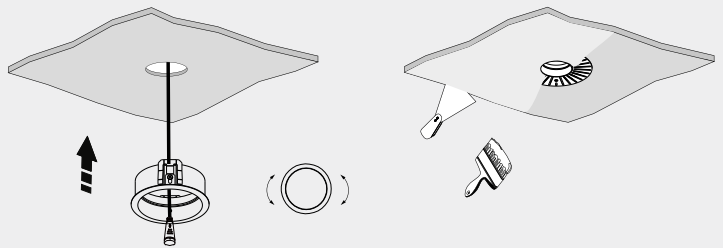

Trim:  
Compress spring plates to  
insert fixture frame to ceiling.

Trimless:  
The frameless embedded parts  
are fixed to the ceiling with screws.  
Plaster up the ceiling to  
hide brackets and screws.

04

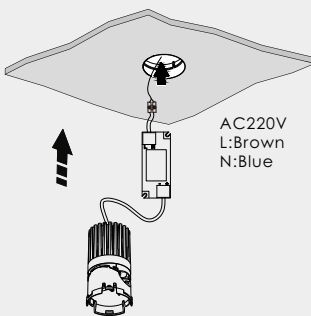

Install the lamp body part into the face frame  
and put it in place.

03



 Take out the reflective front cover before  
installing the lamp body!

05

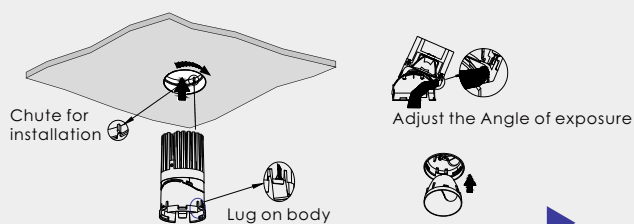

After the body is stuck along  
the chute, turn clockwise.

03

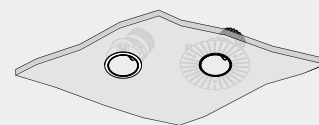





Assembly complete.

# CABIN FAMILY

CABIN series ceiling recessed									
adjustable	Trim recess opening: Ø70								
	Trimless recess opening: Ø120								
accessory									
	Matte Gold (92.6301.MG)	Matte Copper (92.6301.MC)	Matte Silver (92.6301.MS)	Matte White (92.6301.MW)	Matte Black (92.6301.MB)	Trim Accessories (90.2701.WH)	Trimless Accessories (91.2701.WH)	Trimless Accessories (91.2702.WH)	
adjustable	Trim recess opening: Ø100								
	Trimless recess opening: Ø100								
accessory									
	Matte Gold (92.6302.MG)	Matte Copper (92.6302.MC)	Matte Silver (92.6302.MS)	Matte White (92.6302.MW)	Matte Black (92.6302.MB)	Trim Accessories (90.2702.WH)	Trimless Accessories (91.2703.WH)	Trimless Accessories (91.2704.WH)	

# Cabin

Adjustable trim Downlight

-  Ceiling recessed
-  AC 220V~240V
-  Ra 95
-  Lens
-  Class II
-  Ø 70 mm
-  0°~35°
-  0°~355°
-  Matte White (MW)
-  Matte Black (MB)
-  Matte Silver (MS)
-  Matte Copper (MC)
-  Matte Gold (MG)



Wattage	Beam Angle	2700K	3000K	3500K	4000K	2700~6500K
Max. 10W	13°	02.7101.MW	02.7102.MW	02.7103.MW	02.7104.MW	02.7133.MW
		02.7101.MB	02.7102.MB	02.7103.MB	02.7104.MB	02.7133.MB
		02.7101.MS	02.7102.MS	02.7103.MS	02.7104.MS	02.7133.MS
		02.7101.MC	02.7102.MC	02.7103.MC	02.7104.MC	02.7133.MC
		02.7101.MG	02.7102.MG	02.7103.MG	02.7104.MG	02.7133.MG
	24°	02.7105.MW	02.7106.MW	02.7107.MW	02.7108.MW	02.7134.MW
		02.7105.MB	02.7106.MB	02.7107.MB	02.7108.MB	02.7134.MB
		02.7105.MS	02.7106.MS	02.7107.MS	02.7108.MS	02.7134.MS
		02.7105.MC	02.7106.MC	02.7107.MC	02.7108.MC	02.7134.MC
		02.7105.MG	02.7106.MG	02.7107.MG	02.7108.MG	02.7134.MG
	38°	02.7109.MW	02.7110.MW	02.7111.MW	02.7112.MW	02.7135.MW
		02.7109.MB	02.7110.MB	02.7111.MB	02.7112.MB	02.7135.MB
		02.7109.MS	02.7110.MS	02.7111.MS	02.7112.MS	02.7135.MS
		02.7109.MC	02.7110.MC	02.7111.MC	02.7112.MC	02.7135.MC
		02.7109.MG	02.7110.MG	02.7111.MG	02.7112.MG	02.7135.MG
	50°	02.7113.MW	02.7114.MW	02.7115.MW	02.7116.MW	02.7136.MW
		02.7113.MB	02.7114.MB	02.7115.MB	02.7116.MB	02.7136.MB
		02.7113.MS	02.7114.MS	02.7115.MS	02.7116.MS	02.7136.MS
		02.7113.MC	02.7114.MC	02.7115.MC	02.7116.MC	02.7136.MC
		02.7113.MG	02.7114.MG	02.7115.MG	02.7116.MG	02.7136.MG





Dimming: On/Off, 1-10V, DALI, TRIAC  
 UGR: ≤8  
 SDCM: ≤3  
 Luminous efficacy: 78lm/W  
 luminaire Lifetime: 50000h ( L80B10, T a25° C )  
 Material: Aluminium  
 Working Temperature ( °C): -20° C ~ +45° C  
 Transformer availability: LED DC 36V 300mA





# Cabin

Adjustable trimless Downlight

-  Ceiling recessed
-  AC 220V~240V
-  Ra 95
-  Lens
-  Class II
-  Ø 120 mm
-  0°~35°
-  0°~355°
-  Matte White (MW)
-  Matte Black (MB)
-  Matte Silver (MS)
-  Matte Copper (MC)
-  Matte Gold (MG)

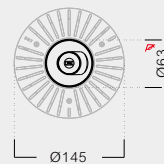
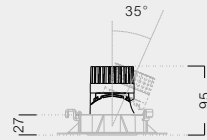

Wattage	Beam Angle	2700K	3000K	3500K	4000K	2700~6500K
Max. 10W	13°	11.7101.MW	11.7102.MW	11.7103.MW	11.7104.MW	11.7133.MW
		11.7101.MB	11.7102.MB	11.7103.MB	11.7104.MB	11.7133.MB
		11.7101.MS	11.7102.MS	11.7103.MS	11.7104.MS	11.7133.MS
		11.7101.MC	11.7102.MC	11.7103.MC	11.7104.MC	11.7133.MC
		11.7101.MG	11.7102.MG	11.7103.MG	11.7104.MG	11.7133.MG
	24°	11.7105.MW	11.7106.MW	11.7107.MW	11.7108.MW	11.7134.MW
		11.7105.MB	11.7106.MB	11.7107.MB	11.7108.MB	11.7134.MB
		11.7105.MS	11.7106.MS	11.7107.MS	11.7108.MS	11.7134.MS
		11.7105.MC	11.7106.MC	11.7107.MC	11.7108.MC	11.7134.MC
		11.7105.MG	11.7106.MG	11.7107.MG	11.7108.MG	11.7134.MG
	38°	11.7109.MW	11.7110.MW	11.7111.MW	11.7112.MW	11.7135.MW
		11.7109.MB	11.7110.MB	11.7111.MB	11.7112.MB	11.7135.MB
		11.7109.MS	11.7110.MS	11.7111.MS	11.7112.MS	11.7135.MS
		11.7109.MC	11.7110.MC	11.7111.MC	11.7112.MC	11.7135.MC
		11.7109.MG	11.7110.MG	11.7111.MG	11.7112.MG	11.7135.MG
	50°	11.7113.MW	11.7114.MW	11.7115.MW	11.7116.MW	11.7136.MW
		11.7113.MB	11.7114.MB	11.7115.MB	11.7116.MB	11.7136.MB
		11.7113.MS	11.7114.MS	11.7115.MS	11.7116.MS	11.7136.MS
		11.7113.MC	11.7114.MC	11.7115.MC	11.7116.MC	11.7136.MC
		11.7113.MG	11.7114.MG	11.7115.MG	11.7116.MG	11.7136.MG

Dimming: On/Off, 1-10V, DALI, TRIAC  
 UGR: ≤8  
 SDCM: ≤3  
 Luminous efficacy: 78lm/W  
 luminaire Lifetime: 50000h ( L80B10, T a25° C )  
 Material: Aluminium  
 Working Temperature ( °C): -20° C ~ +45° C  
 Transformer availability: LED DC 36V 300mA







# Cabin

076

Adjustable trim Downlight

-  Ceiling recessed
-  AC 220V~240V
-  Ra 95
-  Lens
-  Class II
-  Ø 70 mm
-  0°~35°
-  0°~355°
-  Matte White (MW)
-  Matte Black (MB)
-  Matte Silver (MS)
-  Matte Copper (MC)
-  Matte Gold (MG)

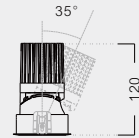

Wattage	Beam Angle	2700K	3000K	3500K	4000K	2700~6500K
Max. 15W	13°	02.7117.MW	02.7118.MW	02.7119.MW	02.7120.MW	02.7137.MW
		02.7117.MB	02.7118.MB	02.7119.MB	02.7120.MB	02.7137.MB
		02.7117.MS	02.7118.MS	02.7119.MS	02.7120.MS	02.7137.MS
		02.7117.MC	02.7118.MC	02.7119.MC	02.7120.MC	02.7137.MC
		02.7117.MG	02.7118.MG	02.7119.MG	02.7120.MG	02.7137.MG
	24°	02.7121.MW	02.7122.MW	02.7123.MW	02.7124.MW	02.7138.MW
		02.7121.MB	02.7122.MB	02.7123.MB	02.7124.MB	02.7138.MB
		02.7121.MS	02.7122.MS	02.7123.MS	02.7124.MS	02.7138.MS
		02.7121.MC	02.7122.MC	02.7123.MC	02.7124.MC	02.7138.MC
		02.7121.MG	02.7122.MG	02.7123.MG	02.7124.MG	02.7138.MG
	38°	02.7125.MW	02.7126.MW	02.7127.MW	02.7128.MW	02.7139.MW
		02.7125.MB	02.7126.MB	02.7127.MB	02.7128.MB	02.7139.MB
		02.7125.MS	02.7126.MS	02.7127.MS	02.7128.MS	02.7139.MS
		02.7125.MC	02.7126.MC	02.7127.MC	02.7128.MC	02.7139.MC
		02.7125.MG	02.7126.MG	02.7127.MG	02.7128.MG	02.7139.MG
	50°	02.7129.MW	02.7130.MW	02.7131.MW	02.7132.MW	02.7140.MW
		02.7129.MB	02.7130.MB	02.7131.MB	02.7132.MB	02.7140.MB
		02.7129.MS	02.7130.MS	02.7131.MS	02.7132.MS	02.7140.MS
		02.7129.MC	02.7130.MC	02.7131.MC	02.7132.MC	02.7140.MC
		02.7129.MG	02.7130.MG	02.7131.MG	02.7132.MG	02.7140.MG

Dimming: On/Off, 1-10V, DALI, TRIAC  
 UGR: ≤8  
 SDCM: ≤3  
 Luminous efficacy: 78lm/W  
 luminaire Lifetime: 50000h ( L80B10, T a25° C )  
 Material: Aluminium  
 Working Temperature ( °C): -20° C ~ +45° C  
 Transformer availability: LED DC 36V 400mA



# Cabin

Adjustable trimless Downlight

-  Ceiling recessed
-  AC 220V~240V
-  Ra 95
-  Lens
-  Class II
-  Ø 120 mm
-  0°~35°
-  0°~355°
-  Matte White (MW)
-  Matte Black (MB)
-  Matte Silver (MS)
-  Matte Copper (MC)
-  Matte Gold (MG)

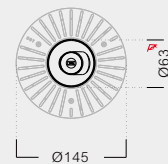
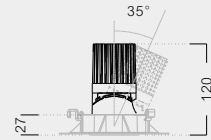

Wattage	Beam Angle	2700K	3000K	3500K	4000K	2700~6500K
Max. 15W	13°	11.7117.MW	11.7118.MW	11.7119.MW	11.7120.MW	11.7137.MW
		11.7117.MB	11.7118.MB	11.7119.MB	11.7120.MB	11.7137.MB
		11.7117.MS	11.7118.MS	11.7119.MS	11.7120.MS	11.7137.MS
		11.7117.MC	11.7118.MC	11.7119.MC	11.7120.MC	11.7137.MC
		11.7117.MG	11.7118.MG	11.7119.MG	11.7120.MG	11.7137.MG
	24°	11.7121.MW	11.7122.MW	11.7123.MW	11.7124.MW	11.7138.MW
		11.7121.MB	11.7122.MB	11.7123.MB	11.7124.MB	11.7138.MB
		11.7121.MS	11.7122.MS	11.7123.MS	11.7124.MS	11.7138.MS
		11.7121.MC	11.7122.MC	11.7123.MC	11.7124.MC	11.7138.MC
		11.7121.MG	11.7122.MG	11.7123.MG	11.7124.MG	11.7138.MG
	38°	11.7125.MW	11.7126.MW	11.7127.MW	11.7128.MW	11.7139.MW
		11.7125.MB	11.7126.MB	11.7127.MB	11.7128.MB	11.7139.MB
		11.7125.MS	11.7126.MS	11.7127.MS	11.7128.MS	11.7139.MS
		11.7125.MC	11.7126.MC	11.7127.MC	11.7128.MC	11.7139.MC
		11.7125.MG	11.7126.MG	11.7127.MG	11.7128.MG	11.7139.MG
	50°	11.7129.MW	11.7130.MW	11.7131.MW	11.7132.MW	11.7140.MW
		11.7129.MB	11.7130.MB	11.7131.MB	11.7132.MB	11.7140.MB
		11.7129.MS	11.7130.MS	11.7131.MS	11.7132.MS	11.7140.MS
		11.7129.MC	11.7130.MC	11.7131.MC	11.7132.MC	11.7140.MC
		11.7129.MG	11.7130.MG	11.7131.MG	11.7132.MG	11.7140.MG

Dimming:

UGR:

SDCM:

Luminous efficacy:

luminaire Lifetime:

Material:

Working Temperature ( °C):

Transformer availability:

On/Off, 1-10V, DALI, TRIAC

≤8

≤3

78lm/W

50000h ( L80B10, T a25° C )

Aluminium

-20° C ~ +45° C

LED DC 36V 400mA



# Installation Schemes

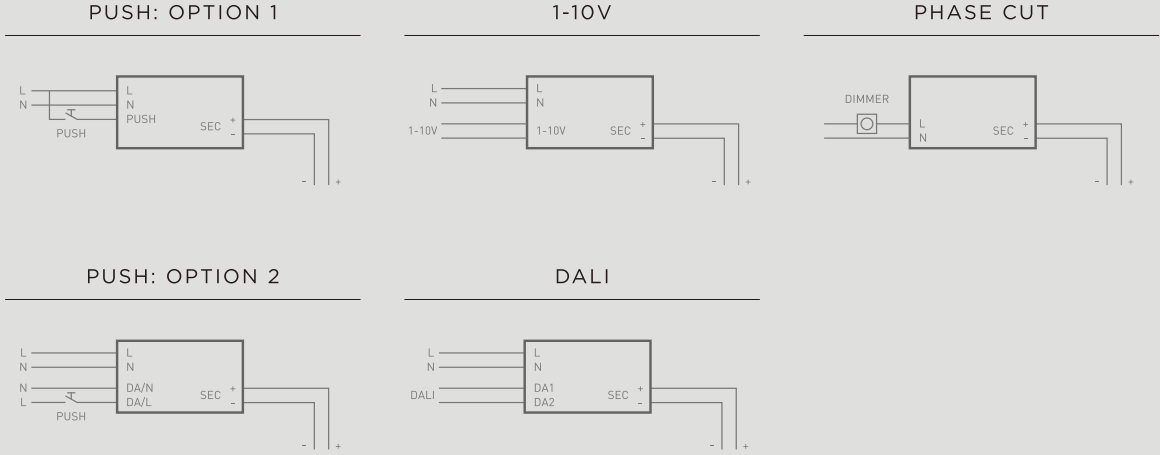

# Connection Tips

SEVERAL FIXTURES CONNECTION TO A SINGLE CONSTANT CURRENT DRIVER

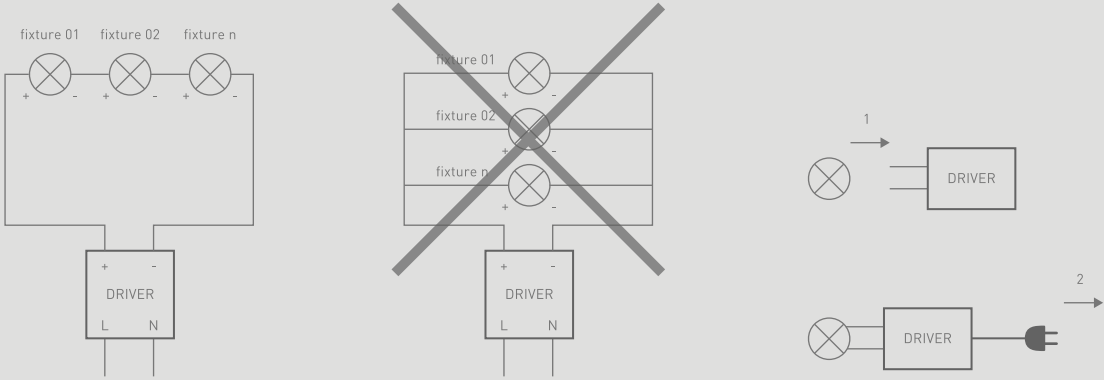

# Trimless Mounting

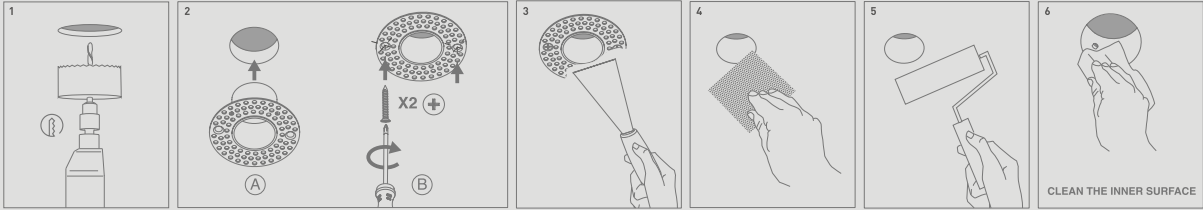

*Publication date: December 2022*

*©Copyright OBT lighting*

*With thank to all contributors for the realization of this catalogue*

*Designed by OBT lighting Graphic Design Department*

*No part of this catalogue may be copied without written authorization of OBT lighting*



## **OBT LIGHTING LIMITED**

Unit G1 Capital House 61  
Amhurst Road, London,  
United Kingdom, E8 1LL  
services@obtlighting.cn  
Hotline : 400 090 2289

[www.obt.ltd](http://www.obt.ltd)



Floor 2, No. 979, Yunhan  
Road, Lingang New District,  
China (Shanghai) pilot Free  
Trade Zone  
services@obtlighting.cn  
Hotline : 400 090 2289

[www.obt.ltd](http://www.obt.ltd)

Office 5, 8/F, Mega Cube,  
8 Wang Kwong Road, Kowloon  
Bay, Kowloon, Hong Kong  
services@obtlighting.cn  
Hotline : 400 090 2289

[www.obt.ltd](http://www.obt.ltd)

Room 201, building 3, No. 67,  
Luoja Nanyue street, Dalong  
street, Panyu District,  
Guangzhou  
services@obtlighting.cn  
Hotline : 400 090 2289

[www.obt.ltd](http://www.obt.ltd)